

**Zydex®**

## THE ULTIMATE ADHESIVE

For Tiles, Marble, Granite & Stones  
Also Prevents Cold Joints cracks

***Cold & Bond***

Very High Bond Strength & Flexibility





**Adhesive for Tiles, Marble, Granite & Stones**  
**Also prevents Cold Joints cracks (Concrete, plaster, Brick joints)**

## THE CHALLENGES

Tile, Marble, Granite & stone joints are vulnerable to water entry, resulting in debonding of these claddings from its base. This leads to seepage / leakage.

PCC (Plain Cement Concrete) or RCC (Reinforced Cement Concrete) are cast in parts, leading to cold joints which develop cracks on ageing. The junction of PCC or RCC structures with brick walls also have cold joints which develop cracks.

Joint between the old and the newly cast part becomes a weak link due to migration of water from newly cast concrete to the cured side.

## ABOUT **ColdBond**

- A unique formulation of nano acrylic technology
- Exhibits dual properties of reactive and nano acrylic copolymer (60-70 nm)
- Offers very high bonding strength
- Makes the concrete surface water resistant
- Ensures polymeric membrane formation.

This results in formation of a very strong and flexible bond, and creation of monolithic joints.

One can actually boil a stimulated joint done with Cold bond, to confirm the water resistance and the strength.

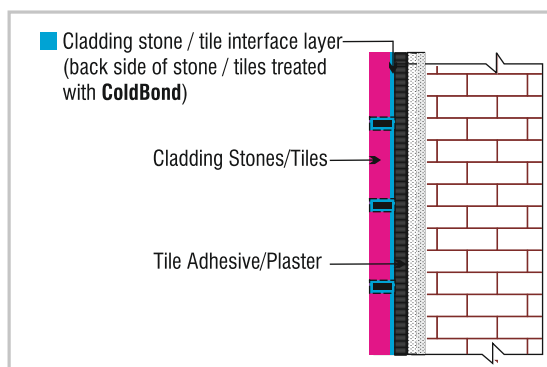

**WALLS AND CLADDINGS**

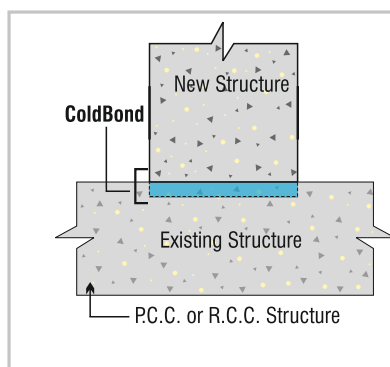

**COLD JOINTS – HORIZONTAL**

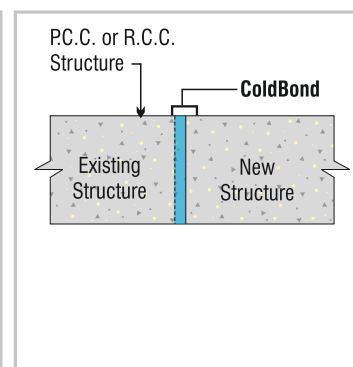

**COLD JOINTS – VERTICAL**

## SPECIFICATIONS

Appearance	Translucent Liquid Dispersion
Viscosity at 25°C	< 50 cps
Specific gravity range	1 to 1.02
Flash Point	Above 68 °C
Odour	Low Odour
Solubility	Easily dispersible in water
pH	Approx. 6 ± 1
Particl Size	60-90 nm

### PACKAGING

1, 5, 20 ltrs

### SHELF LIFE

48 months when stored as recommended.

### STORAGE

Store in a shaded area away from direct sunlight, between 5-45 °C. Protect from extreme temperatures.

### APPLICATION

Dilute ColdBond with potable water @ 1:1.  
 Apply by Brush on the tile / stone / marble / granite / cold joints of concrete, plaster or bricks

### DISCLAIMER

Whilst the information contained herein is true, accurate and represents our best knowledge and experience, no warranty is given or implied with any recommendations made by us, our representatives or distributors, as the conditions of use and the competence of any labour involved in the application are beyond our control.



### ZYDEX INDUSTRIES

61, Gotri Sevasi-Road, Vadodara - 390 021, Gujarat, INDIA.

Tel : +91 265 3312000 Toll Free No. : 1800 - 3000 - 7144

E-mail : [waterproof@zydexindustries.com](mailto:waterproof@zydexindustries.com) [www.zydexindustries.com](http://www.zydexindustries.com)